

ACCOMMODATIONS SYMBOL LEGEND

- ★ 2 Twin Beds (convert to King) and Single Sofa Bed
- 2 Twin Beds (convert to King) and 1 Upper Pullman
- ◇ 2 Twin Beds (convert to King), 1 Lower Pullman, and 1 Upper Pullman
- ⋮ 2 Twin Beds (convert to King) and 2 Upper Pullmans
- † 2 Twin Beds (convert to King) and Double Sofa Bed
- ◆ Stateroom with 2 Porthole Windows

- ◁ Connecting staterooms (ideal for families and groups of friends)
- ★ Twin beds do not convert to a King Bed.
- U Unisex Wheelchair Accessible Restroom
- Ⓜ All accommodations are non-smoking.

Staterooms are available that are modified for wheelchair users. Please contact Carnival Reservations Department, Guest Access Services, at 1-800-438-6744, ext. 70025, for details.

CATEGORIES

- | | |
|----------------------------|------------------------------------|
| 1A Interior Upper/Lower | 08 Junior Suite (obstructed views) |
| PT Porthole | 05 Junior Suite |
| 4A 4B 4C 4D 4E 4I Interior | 06 Grand Suite |
| 6A 6B 6C 6D 6E Ocean View | |

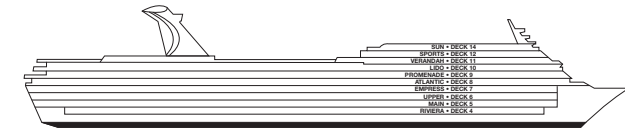

Gross Tonnage: 70,367 Length: 855 Feet Beam: 103 Feet
 Cruising Speed: 21 Knots Guest Capacity: 2,052 (Double Occupancy)
 Total Staff: 920 Registry: Panama

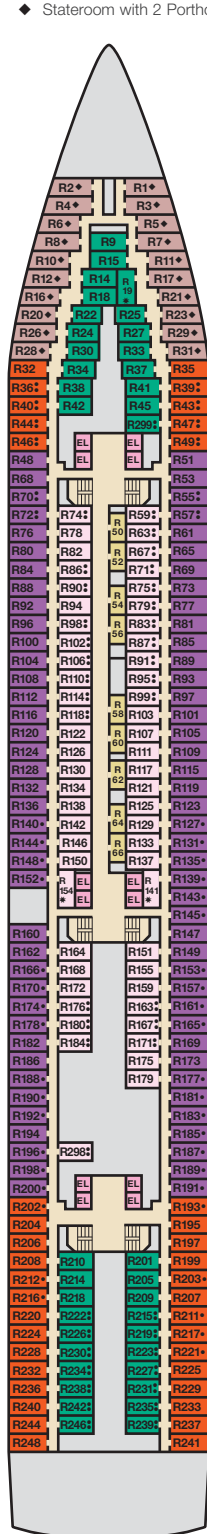

Riviera • Deck 4

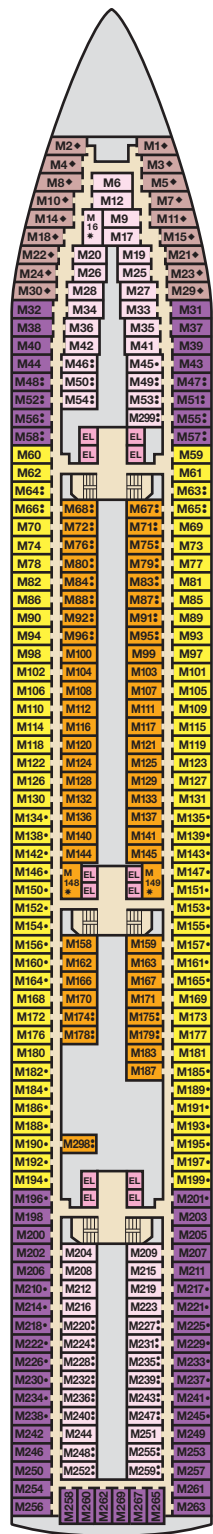

Main • Deck 5

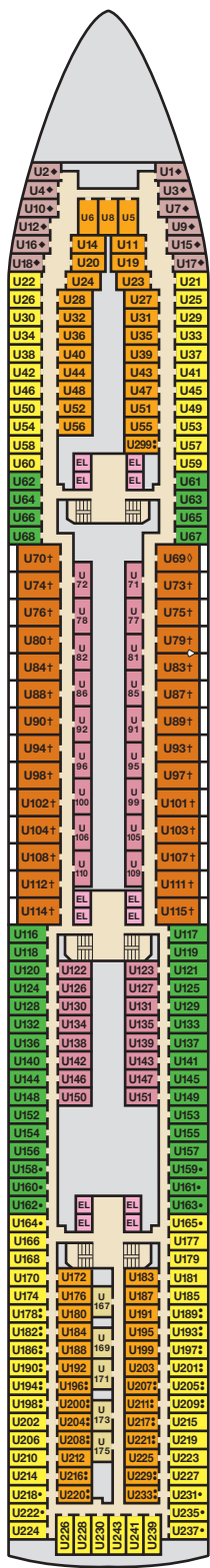

Upper • Deck 6

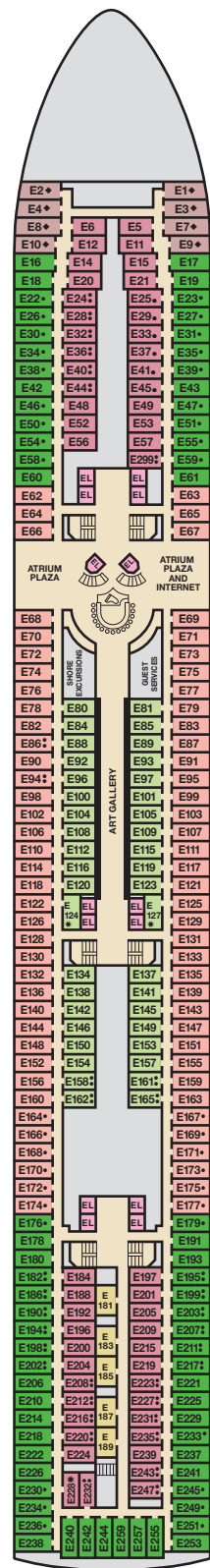

Empress • Deck 7

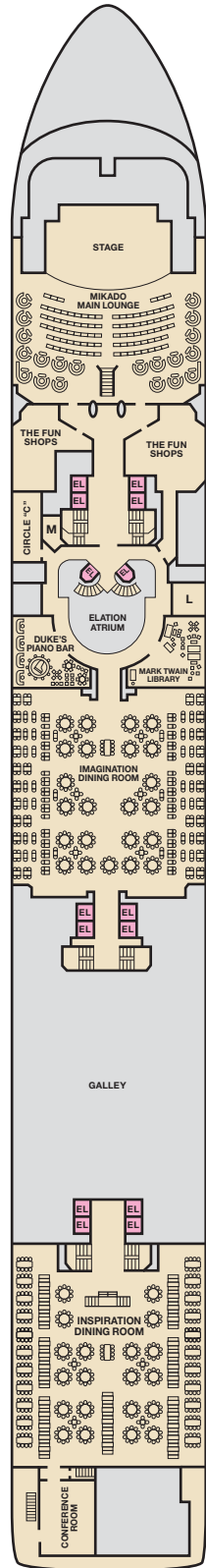

Atlantic • Deck 8

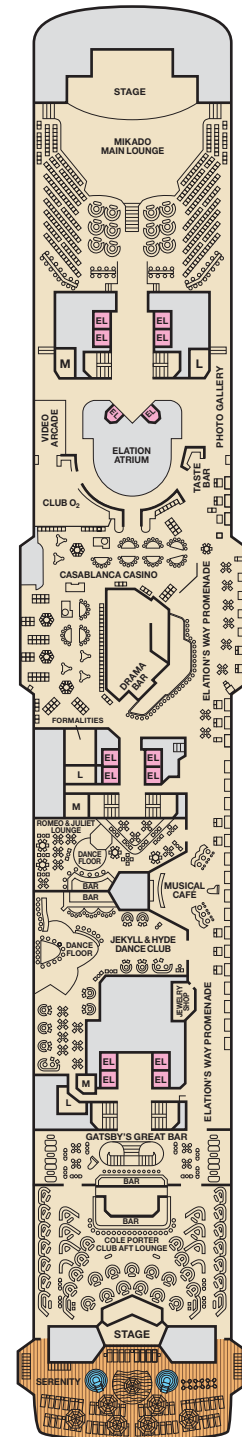

Promenade • Deck 9

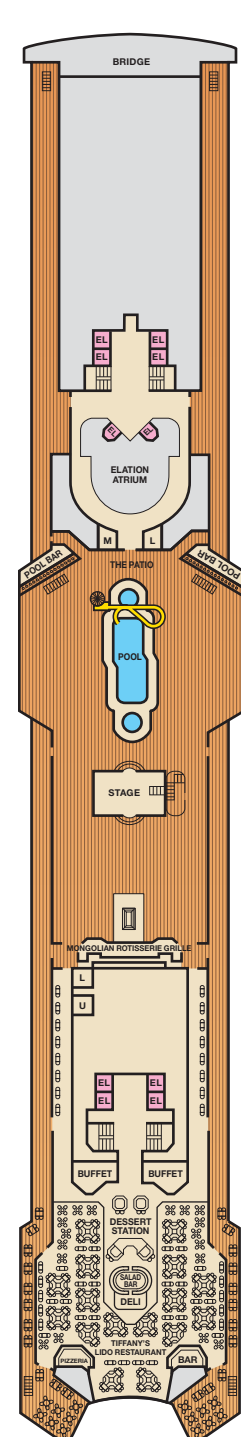

Lido • Deck 10

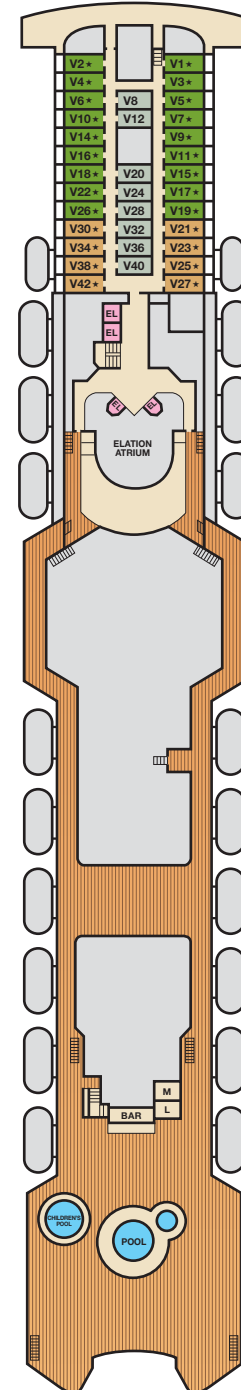

Verandah • Deck 11



Sports • Deck 12

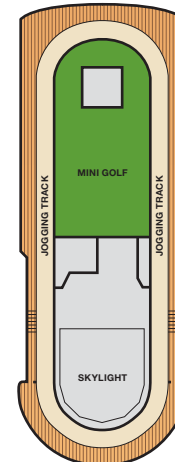

Sun • Deck 14